

RATHI Europe

RATHI RF = RATHI Fuse

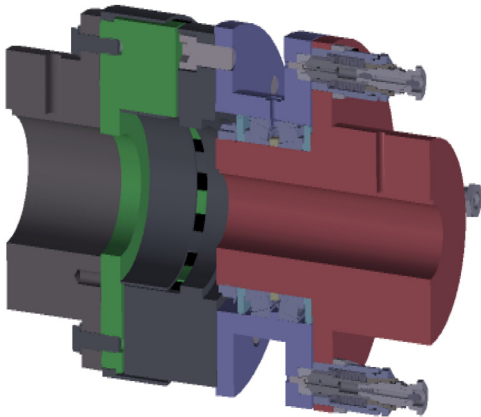

RATHI mechanical fuses are available in 2 standard versions:
RF M = manual reset for high torque ranges



- RATHI RF units, are working as resettable mechanical fuses. Immediate after an overload the mechanical fuses are releasing the load side and allow the motor to rotate idle. Now the motor can't transmit any power into the drive train, This avoids that motor power and inertia causes damage to gear boxes and other drive components. The fuses open in ms and in this form quicker as any other protective device.
- The design is very flexible. By placing the fuses at variable distance to the center of the shafts and in various sizes and designs nearly any torque and form is possible.
- Combinations with flexible couplings, cardan shafts, flanges etc. makes this fuse ideal for customized solutions.

RATHI RF A = automatic reset by reversing the sense of rotation at the driving machine.

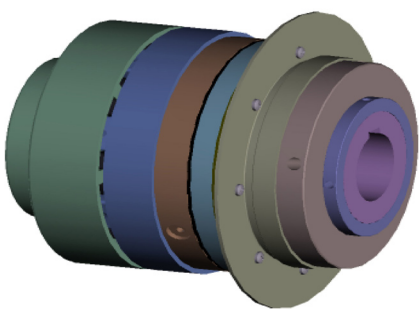

RATHI RF A fuses combine perfect protection with rapid and accurate reset to allow the production to be fastest back in operation without risk of damage. Low cost of ownership is the result.

- Free spinning after an overload. The motor is disconnected from the drive train and can't add damaging force to the blocked drive.
- Easy reset by rotating the motor backwards either manual or with help of the motor control. The operator has full control.
- Fast reaction time, Only ms are needed to operate the clutch.
- Combinations with elastomeric or metal couplings allow the compensation of misalignment in the drive train.
- Automatic reset reduce the reset time to a minimum.
- For the usage under severe outdoor conditions optional protective coatings and covers are available.